

LAND AUCTION

THURSDAY, AUG. 26, 2010 – 10:00 A.M.

Shattuck, OK

Ellis County Fairgrounds

400 Acres of Ellis County

Land
CRP and
Grassland
Surface
Only

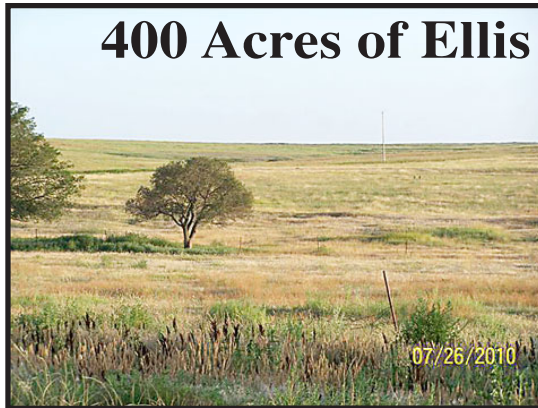
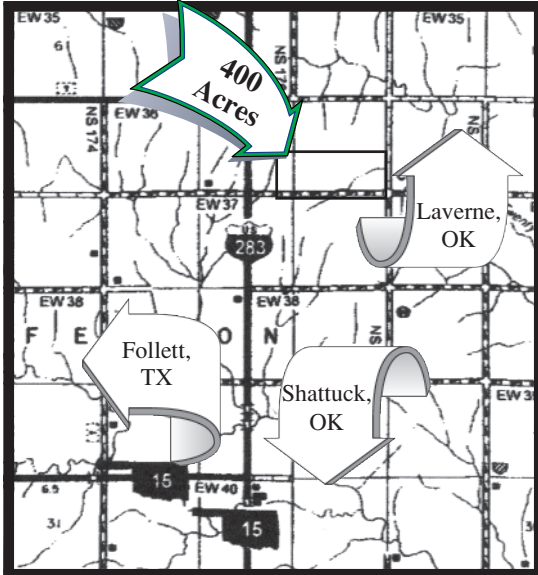

The E1/2 SE1/4 of Section 9, Township 23N, Range 25W;
and S1/2 of Section 10, Township 23N, Range 25W in
Ellis Co., Oklahoma

Property is located at Corner of County Roads N/S 177
and E/W 37. From Shattuck, travel 14 miles North on
U.S. 283 to Trunkline Road (E/W County Road 37) then
East 1/4 mile. From Log Cabin Corner, travel 10 miles
South on U.S. 283 to Trunkline Road then East 1/4 mile.

This property is native grass pasture and contains 236.3 acres @\$30/ac. Conservation Reserve
Land 41.7 acres wheat base, 25 bushel yield. There is a windmill for water on the property.

TERMS: 10% of the purchase price is to be placed in escrow the day of sale, remainder upon closing. Closing costs will be divided between buyer and seller as set forth on sales contract to be executed by successful bidder day of sale. Buyer will have 30 days for title examination. All information has come from sources believed to be reliable, however buyers should satisfy themselves as to conditions, boundaries, fences, water well specifics. Sale is subject to seller approval. Contact M. Kent Bentley with questions and other information @938-1468.

SELLER: MARK MORGAN



Robert Young Real Estate Broker
Residential, Commercial, Farms/Ranches

312 S. Main • Shattuck, OK
sksinsurance.com • Cell: 580-938-1500



Walt Wagon 939-2281 • Mike "Hoss" Manske 334-5613
M. Kent Bentley 938-1468

**Stuart
Keffer &
Schoenhals
Inc.**
938-2326